

# MY LED LIGHTING GUIDE

## YOUR GUIDE TO ENERGY EFFICIENT LED LIGHTING

### INSTALLATION GUIDE

#### IMPORTANT SAFETY INFORMATION:

Please read all the instructions below before installation.

- ▶ Make sure that the supply voltage corresponds to the rated product voltage.
- ▶ The product must be installed by a qualified electrician in accordance with the National Electrical Code and corresponding local codes.
- ▶ If the product is damaged, do not use it.
- ▶ All wiring connections should be capped with UL approved wire connectors.
- ▶ This fixture is intended to be connected to a properly installed and grounded UL listed junction box with suitable strain relief means for power cord. The junction box is not included, should be purchased separately.

#### INSTALLATION STEPS

1. Use a screwdriver to loosen (2) screws securing fixture door and open it.
2. Mounts to junction box or directly to wall.
  - 2.1 Take care to avoid damaging driver, wires and quick connectors and drill holes through castings over fixture. Hang the fixture on the back plate. Connect wires into wiring terminal; white wire to "Neutral" terminal, black wire to "Live" terminal, green wire to "Ground" terminal; and fix them by screws connect the ground wire to the back plate.
  - 2.2 Replace one of the side caps, insert power cord into fixture and connect the wires as shown on picture 2.2. Refer to size of the diagram to bore the holes on the wall.
3. Close fixture and tighten the 2 screws removed in installation step 1.

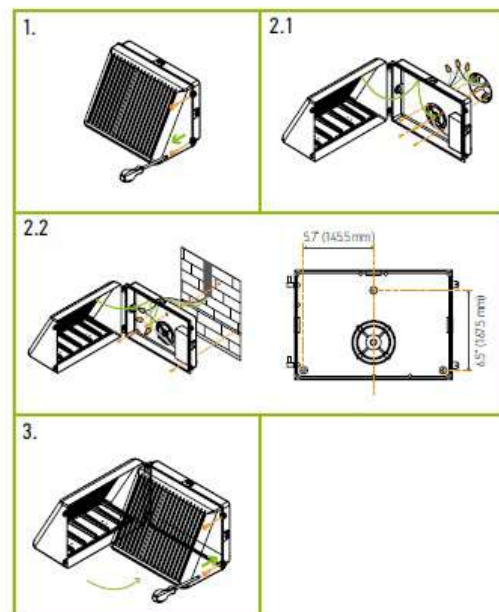

#### CONNECTION DIAGRAM DIMMABLE

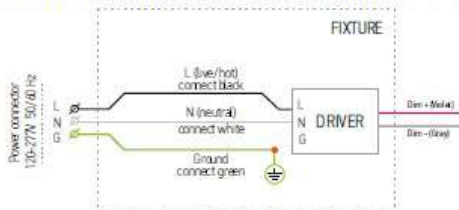

#### CONNECTION DIAGRAM NON-DIMMABLE

