



**6 Degree XR-E Collimator Lens - Part No. 170**



- » Specifically designed for Cree XR-E High Power LED's
- » High light collection efficiency of >85%
- » Precision moulded in optical grade Polycarbonate for thermal stability and system durability
- » Part of the Polymer Optics "Modular LED Optics"® range

Polymer Optics "Modular LED Optics"® design, based on a hexagonal format, allows maximum packing density and assembly flexibility

Supplied with Holder (Part No. 147) to mount optics directly on to PCB's. Holder locates on LED package to ensure correct alignment

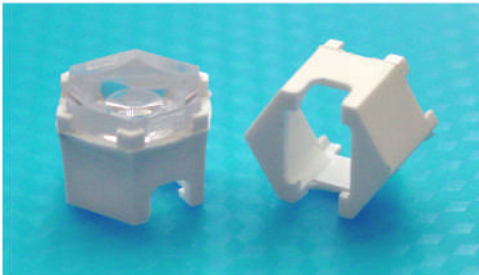

Typical dimensional tolerances to +/-0.2mm

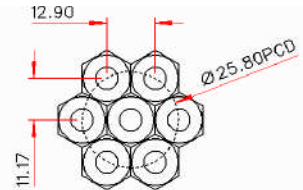
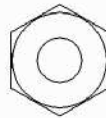

NESTED COMPONENTS ON 25,8MM PCD

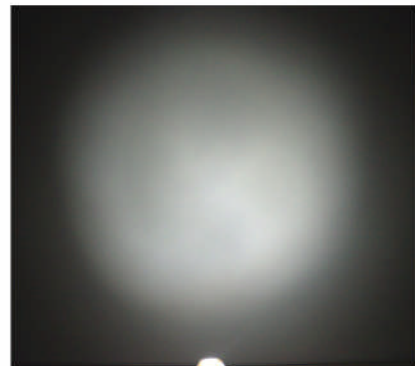
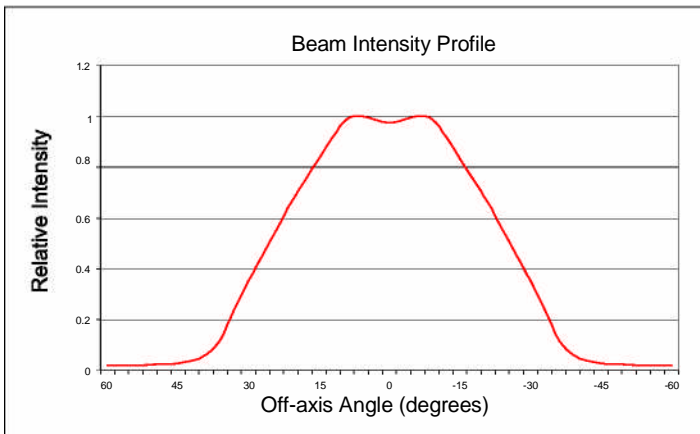
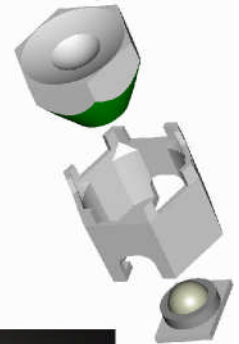
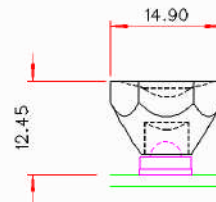
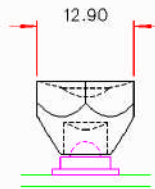

**6x25 Degree XR-E Line Lens - Part No. 172**

Due to continuous product improvement, POL reserve the right to change specifications without notice

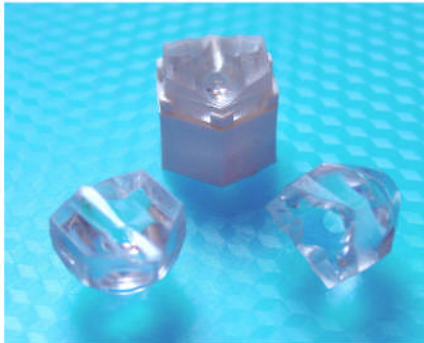

- » Specifically designed for Cree XR-E High Power LED's
- » High light collection efficiency of >85%
- » Precision moulded in optical grade Polycarbonate for thermal stability and system durability
- » Part of the Polymer Optics "Modular LED Optics"™ range

Polymer Optics "Modular LED Optics"™ design, based on a hexagonal format, allows maximum packing density and assembly flexibility

Supplied with Holder (Part No. 147) to mount optics directly on to PCB's. Holder locates on LED package to ensure correct alignment

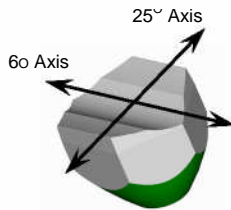

Typical dimensional tolerances to +/-0.2mm

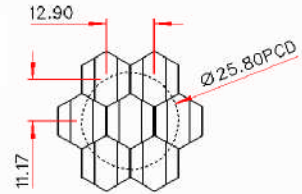

NESTED COMPONENTS ON 25,8MM PCD

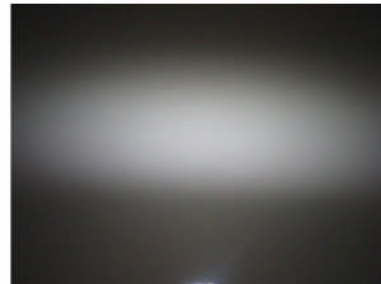
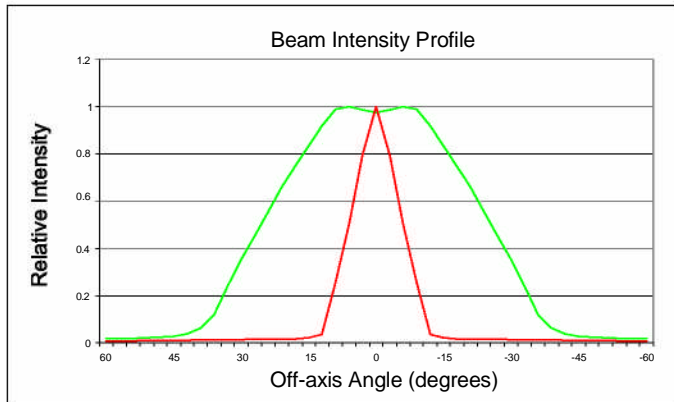
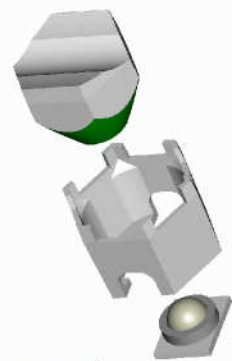
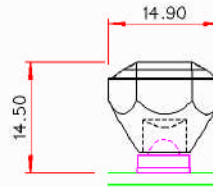
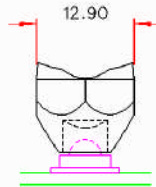
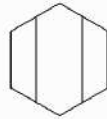

Due to continuous product improvement, POL reserve the right to change specifications without notice.

### Single Cell XR-E Concentrator Lens - Part No. 173

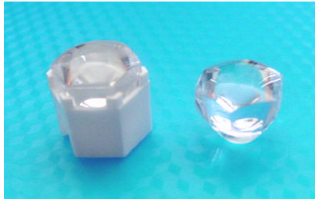

- Specifically designed for Cree XR-E High Power LED's
- High light collection efficiency of >85%
- Precision moulded in optical grade Polycarbonate for thermal stability and system durability
- Part of the Polymer Optics "Modular LED Optics"<sup>®</sup> range

Polymer Optics "Modular LED Optics"<sup>®</sup> design, based on a hexagonal format, allows maximum packing density and assembly flexibility

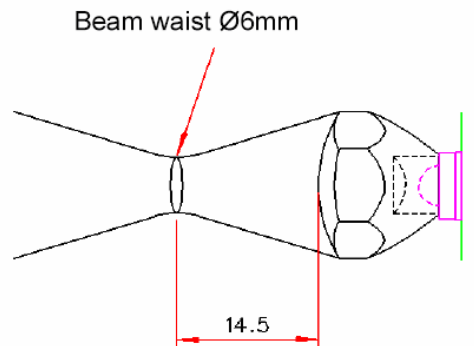
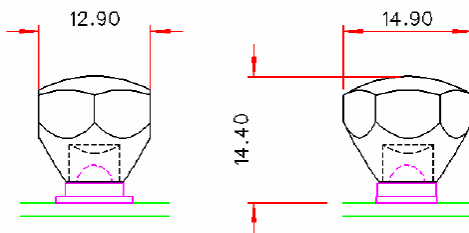
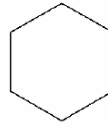

#### Typical Applications:

- Beam insertion into optical fibre bundles
- Beam insertion into edge of lightguides

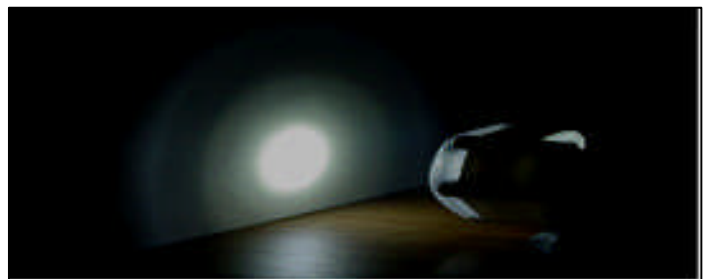

**Cree XLamp LED Lens Holder - Part No. 147**

- Designed for use with Polymer Optics “Modular LED Optics”<sup>®</sup> and custom Polymer Optics designs
- Designed to operate with Cree XR-E High Power LED’s
- Simply mounts onto PCB and self-aligns to LED
- Precision moulded in optical grade Polycarbonate for thermal stability and system durability

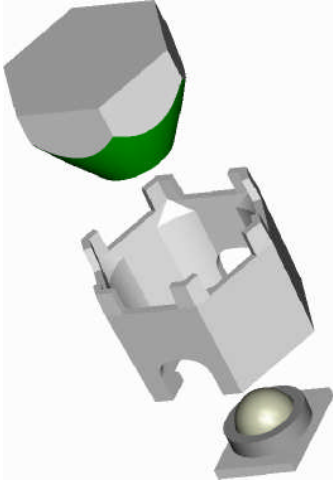

- Part of the Polymer Optics “Modular LED Optics”<sup>®</sup> range

- Polymer Optics “Modular LED Optics”<sup>®</sup> design, based on a hexagonal format, allows maximum packing density and assembly flexibility.

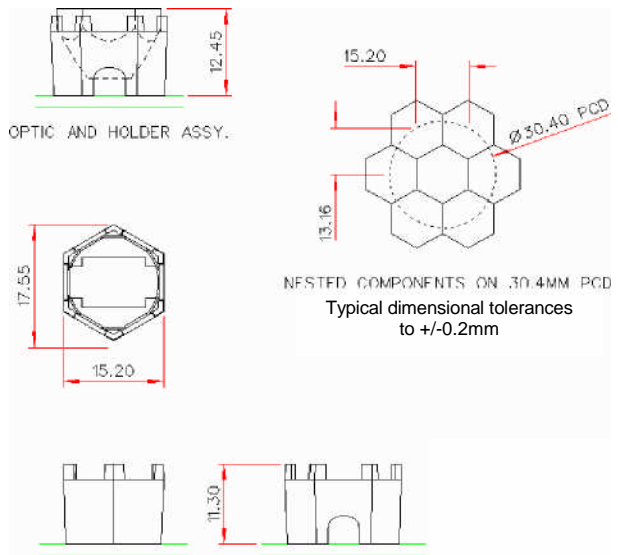

- High intensity illumination of small objects for inspection and microscopy

